



GREENWICH
flagship events

Contents

01 **Dreadnought Building**

02 **Quad Exhibition Atrium**

03 **Meeting Rooms**

04-09 **Lower Deck**
 Rooms
 Atlantis
 Floor Plan
 Food / Drink
 Outdoor Garden Space

10 **Contact Information**

Dreadnought Building

Originally built in 1764 as part of the Greenwich Hospital the building was eventually acquired by the university in 1998 and hosted a library for 15 years. The building is part of the Maritime Greenwich World Heritage Site, where internationally significant architecture and landscape, artistic achievement, scientific endeavour and royal association come together to tell the story of Britain at sea.

After a multi-million-pound refurbishment in 2018, the Dreadnought building is now the centre of the University of Greenwich. The building retains its character and sense of history while also being a state-of-the-art hub providing learning facilities, 500-person capacity bar and social spaces.

Flagship Events is proud to offer this space for hire, which includes meeting rooms, the Quad exhibition space and its underground venue, the Lower Deck.

Please note that this venue is used within a university and therefore may have some restrictions on availability.

01



Quad Exhibition Atrium

Situated within the Dreadnought Building, Union Events can offer a variety of rooms to suit your needs.

Our Quad Exhibition Atrium is available for exclusive hire only (out of term time) and is perfect for large networking events, art exhibitions, awards evenings and filming.

All of our spaces are equipped with AV capabilities, HDMI inputs to connect external laptop to screen, WIFI access, Plug sockets and USB inputs.



🏠 200 🧑 280





The Boardroom



Small Room



Medium Room



Small Room



The Boardroom



Large Room

03

Small Room	10	15	129ft ²	Large Room	30	30	377ft ²
Medium Room	20	20	194ft ²	The Boardroom	60	80	861ft ²

Meeting Rooms

Lower Deck

Subject to availability/council approved extended hours.

A vessel's lower deck was sometimes where sailors would live, eat, drink, and have a good time on their voyages across the sea.

The Lower Deck is made up of 5 unique spaces—including a unique outdoor garden space—located beneath the Dreadnought Building on the Royal Naval College Campus in Greenwich. The venue is incredibly versatile with a capacity of 500, a 2.00am licence on Fridays and Saturdays and comes with an outdoor garden space. Located in Greenwich it offers transport links from the City, central London and Canary Wharf. With a state-of-the-art sound system and visual capabilities, the Lower Deck is the ultimate blank canvas space for club nights, concerts, private functions, product launches and experimental events.





Main Bar



The Saloon Bar



The Mermaid Tunnel



The Kraken Room



The Saloon Bar

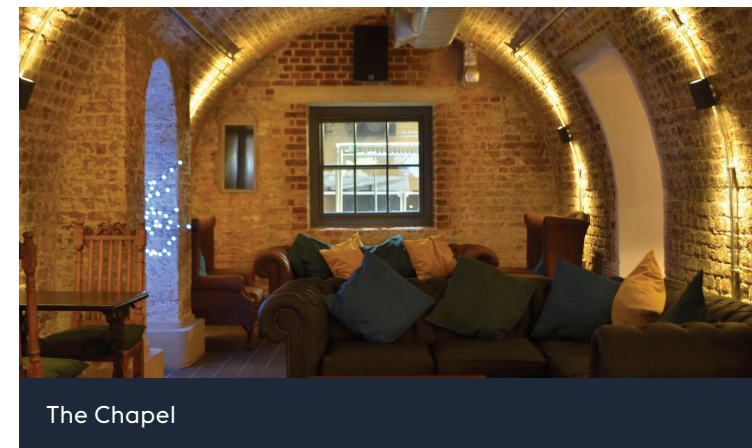

The Chapel

05

The Saloon Bar 🍷 40 🧑 60-80
 The Kraken 🍷 30 🧑 20-30

The Chapel 🍷 12 🧑 10-15
 The Mermaid Tunnel 🍷 15 🧑 20-25

Lower Deck



06

Large dance floor area with stage and DJ booth. The space features 3M video wall, Martin Audio Sound System, industry standard DJ-ing equipment and live music capabilities.

🗨 90 🧑 150-250

Atlantis

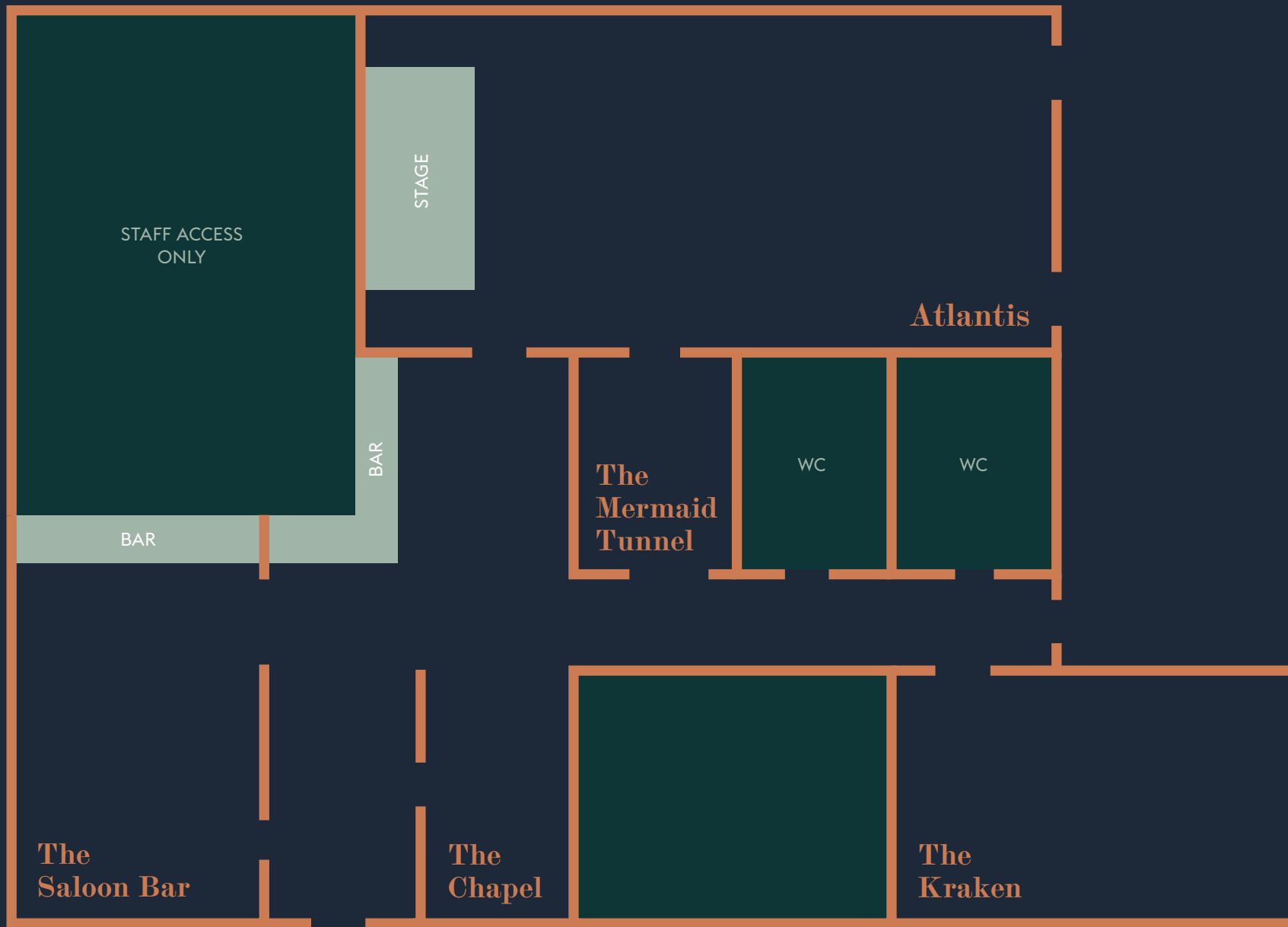

ENTRANCE/
FIRE EXIT



Lower Deck—Floor Plan

Food & Drink

Our large bar is stocked and ready to serve classic beers, sophisticated wines and hand-crafted cocktails alongside a fantastic food menu.

Dietary requirements are well catered for, with a number of vegetarian, vegan and gluten-free dishes. We also serve a range of mocktails if you want something soft, fun and fruity. Additionally, our hot drinks are not only delicious, but sustainably sourced through the award-winning hot beverage brand Cafeology.



Outdoor Garden Space

The Lower Deck garden is situated right outside the main entrance and is spacious, secluded and frequently sought after in the Summer months. It comes ready to seat 40 guests however this capacity can be expanded by making use of the surrounding space.

It has festoon lights around one edge, underfloor lighting as well as standing lights dotted throughout.

It's perfect for small to medium outdoor functions or can be used as an extension/beer garden to accompany larger events taking place within the Lower Deck.

Additional equipment hire

3x3m marquee: £100 + VAT.



Contact Information

Email us

flagshipevents@greenwich.ac.uk

Location

Dreadnought Building,
30 Park Row,
SE10 9HU

We can source any additional event,
catering or AV equipment required for
your booking.

